

# CLIFFS NORTH

WIXOM, MICHIGAN

EXCEPTIONAL HOMES. EXCEPTIONAL LOCATION.

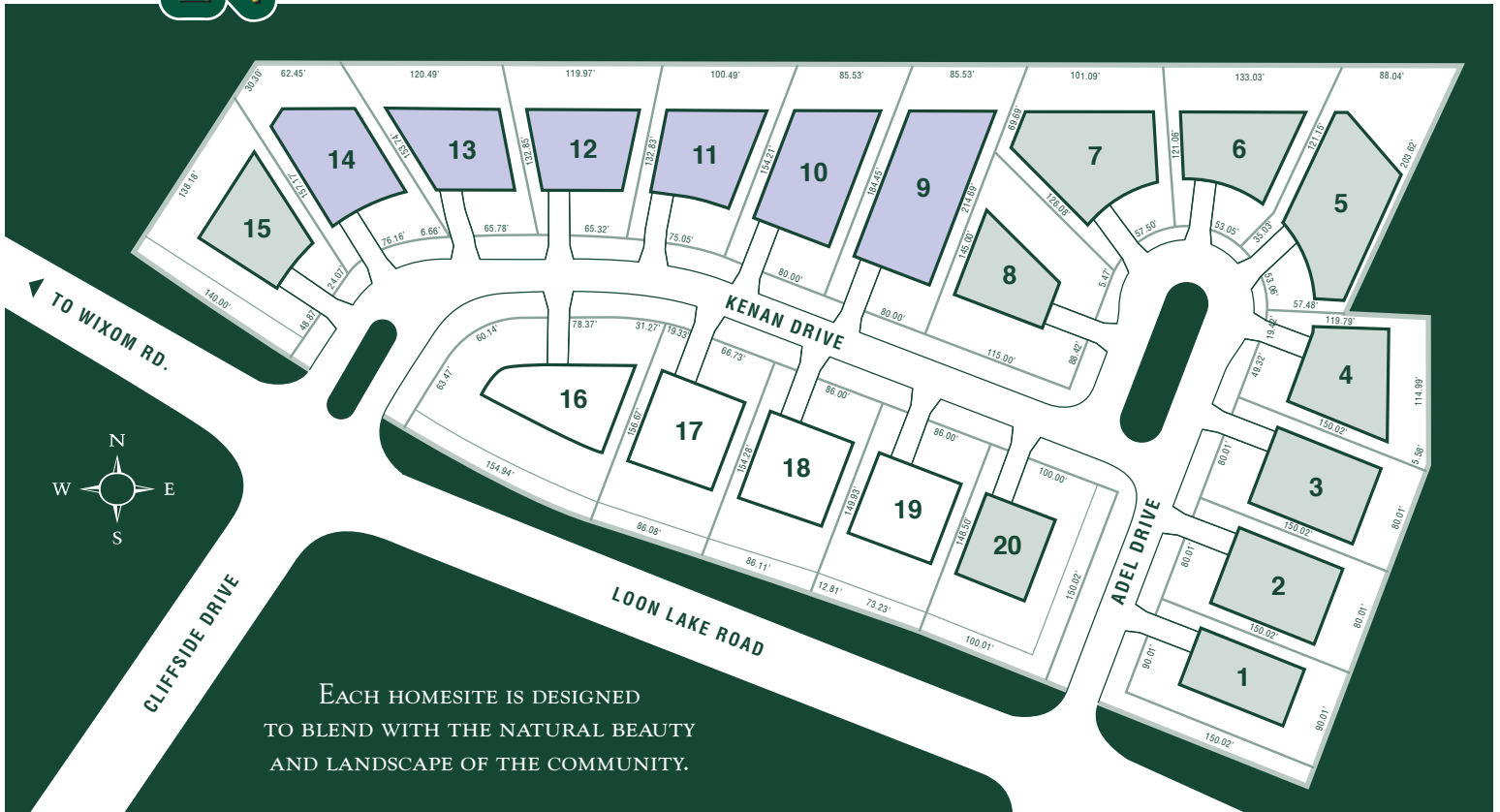

Each homesite is designed to blend with the natural beauty and landscape of the community.

- DAYLIGHT BASEMENT
- WALKOUT BASEMENT
- STANDARD BASEMENT

Cliffs North features timeless architecture, desirable design elements and unsurpassed build quality. Enjoy craftsmen-inspired home designs, nestled in an intimate family-friendly community within the Walled Lake School District. The thoughtful combination of natural details and well-suited amenities makes Cliffs North the perfect place to call home.

Visit our model located in the Hills of Loon Lake at 2720 Trillium Hills Drive, Commerce Township, MI 48382. Located approximately one mile North - take Wixom Rd. to Glengary Rd. See map on back for more details.



For more information or to schedule a meeting in person, please contact a member of our sales team at 248-220-6860 or email [JohnM@pinecovebuilding.com](mailto:JohnM@pinecovebuilding.com)

All information contained herein was accurate at the time of publication. We reserve the right to make changes, modify or remove any trees or vegetation in the community without notice or obligations. Drawing not to scale.  
 © 2015 Pine Cove Building  
 © 2015 Cliffs North LLC. All rights reserved.